



FLORIDA DEPARTMENT OF TRANSPORTATION

TRAFFIC DETOURS FOR DRAINAGE WORK

SW Port St. Lucie Boulevard Widening Project

South of SW Alcantarra Boulevard to South of SW Darwin

Boulevard in the City of Port St. Lucie, FL

Financial Project ID Number: 431752-6-52-01



Full Closure of S Globe Ave. at SW Port St. Lucie Boulevard extended through Mar. 15

The City of Port St. Lucie, as Project Sponsor, requested that the Florida Department of Transportation (FDOT) design and construct the SW Port St. Lucie Boulevard Widening Project, through application to the St. Lucie Transportation Planning Organization and City of Port St. Lucie Resolution 18-R42. FDOT is pleased to assist with completing these improvements. Please see below for more information on detours required for the drainage work.

Construction Cost: \$11,570,179 Construction Start: January 27, 2022 Anticipated Completion: Summer 2024

DRAINAGE STRUCTURE INSTALLATION ACROSS S GLOBE AVENUE AT SW PORT ST. LUCIE BOULEVARD

- Beginning at 8 a.m. Monday, February 26, 2024, S Globe Avenue at SW Port St. Lucie Boulevard will be closed around-the-clock through approximately 5 p.m. Friday, March 15, 2024, for drainage structure installation and road restoration. Monday, Mar. 18 through Friday, Mar. 22 will be used as contingency dates if needed.
- Northbound and southbound SW Port St. Lucie Boulevard to westbound S Globe Avenue will be detoured via SW North Globe Avenue and W Globe Avenue to S Globe Avenue.
- Eastbound S Globe Avenue motorists will be detoured via W Globe Avenue and SW North Globe Avenue to SW Port St. Lucie Boulevard.

PROJECT IMPROVEMENTS

- Widen SW Port St. Lucie Boulevard from a two-lane undivided roadway to a four-lane divided roadway
- Install three (3) new signalized intersections with mast arms at SW Alcantarra Boulevard, SW Tulip Boulevard, and SW Tunis Boulevard
- Add a right turn lane on SW Port St. Lucie Boulevard's north approach to SW Alcantarra Boulevard
- Construct an 18-foot wide raised median with curb and gutter
- Upgrade crosswalks and curb ramps to meet Americans with Disabilities Act (ADA) standards
- Construct 8 to 10-foot wide sidewalks on both sides of SW Port St. Lucie Boulevard for pedestrian and bicycle use, and 6-foot wide sidewalks on side streets
- Install new closed drainage system, pond, signing, pavement markings, signalization, and lighting upgrades
- Add landscaping to median, install irrigation, and stamped concrete

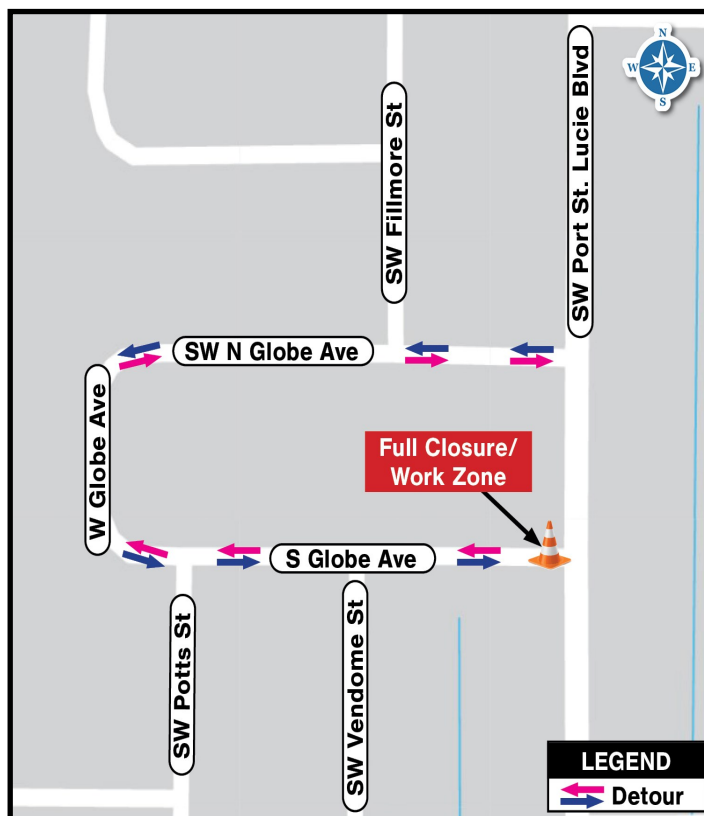

CONTACT INFORMATION

Mark Freeman, FDOT Project Manager

mark.freeman@dot.state.fl.us or (772) 429-4904

Luke Brolmann, P.E., Project Administrator

lbrolmann@jmt.com or (772) 528-3627

Samantha Kayser, Community Outreach Specialist

skayser@corradino.com or (772) 579-5479

WEB & SOCIAL MEDIA

Project Website: www.d4fdot.com

Facebook: www.facebook.com/MyFDOTSEFL/

Instagram/X: @MyFDOT_SEFL



FLORIDA DEPARTMENT OF TRANSPORTATION MISSION STATEMENT

The Department will provide a safe transportation system that ensures the mobility of people and goods, enhances economic prosperity, and preserves the quality of our environment and communities.

Please contact the Community Outreach Specialist, Samantha Kayser, to be added to project email notification lists. Public participation is solicited without regard to race, color, national origin, age, sex, religion, disability, or family status. Para información y preguntas en Español, por favor llame al (954) 777-4302.

Updated: 1/18/2024